

# Rat Barrier



The Hepworth Clay Rat Barrier prevents sewer rats from entering domestic or commercial premises via the drainage system. The Rat Barrier has been carefully designed for ease of installation and operation by substituting the rest bend for a Rat Barrier at the base of each soil and ventilation stack. Normal soil stack operation is unaffected, ensuring health and hygiene for the buildings occupants.

## Benefits

- Ensures health and safety for building occupants
- Quick and easy to install in new build applications
- Universal – connects to clay or plastic drainage systems
- Inexpensive to install
- No maintenance – there are no operational parts inside
- Manufactured from durable clay with low lifetime cost
- Prevents rodent entry in food retail outlets

## Applications

Rats are able to scale the vertical ventilation and soil pipes into dwellings with remarkable ease, splaying out all four legs and using their back to support themselves against the pipe. The Rat Barrier effectively provides a chamber which is too high for a rat to jump up, and too broad for a rat to vertically ascend. The curved shape of the base section incorporates a long radius rest bend to maintain hydraulic efficiency of the soil stack and compliance with Building Regulations, whilst excluding the presence of a suitable platform to leap from.

The diagram below indicates installation options for the Rat Barrier.

## Product information

Product Code RAT/FM

H	Overall height	1150mm
N	Depth to invert	970mm
H1	Effective height	140mm
D	Internal diameter	175mm
I	Inlet diameter	110mm

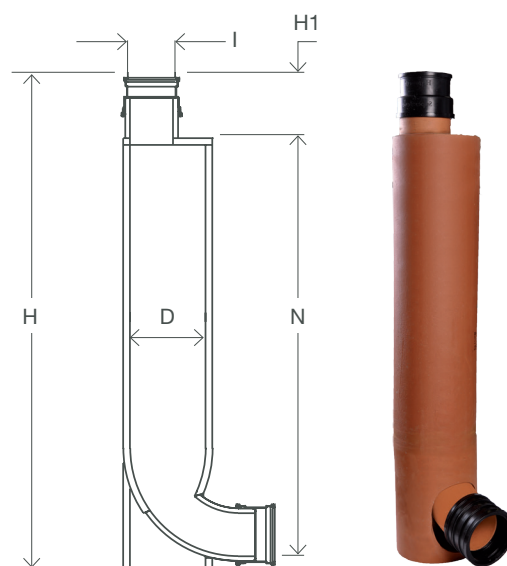
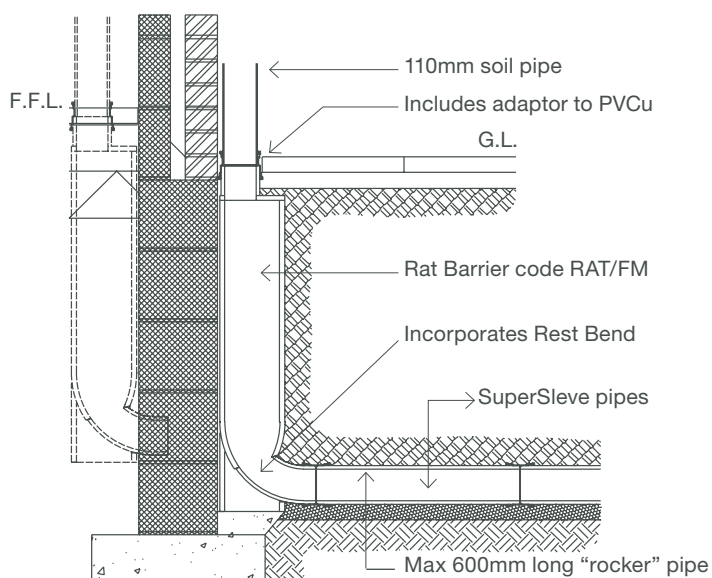

N.B. The height of this product may require the use of a deep inspection chamber.